

TIED CURB & GUTTER JOINT:  
1/2" x 18" @ 30" O.C.  
EPOXY COATED DEFORMED BARS

REFER TO STR-17C FOR  
SECTIONS VIEWS A-A, B-B,  
AND C-C.

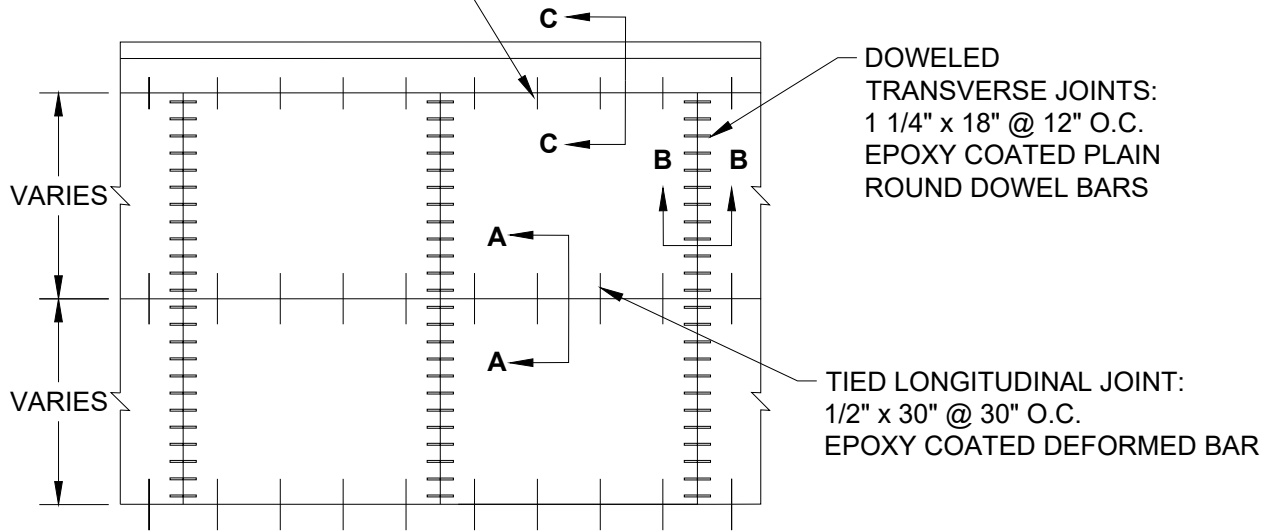

**FULL PANEL REPAIR - PCC PAVEMENT (8" TO 10" THICK)**  
NOT TO SCALE

**NOTES:**

1. T = PAVEMENT THICKNESS
2. ALL JOINTS TO BE SEALED.
3. ALL TIE BARS TO BE GRADE 40 STEEL.
4. ALL DOWEL, TIES, REINFORCING STEEL TO BE EPOXY COATED.
5. MAINTAIN 3" CONCRETE COVER AROUND ALL METALS.
6. PAVEMENT REPAIRS SHALL MATCH EXISTING DEPTHS.
7. ALL SUB-CUT AREAS OF BASE, SUB-BASE, AND SUBGRADE MUST BE APPROVED BY THE ENGINEER. CONTRACTOR SHALL NOT BE PAID FOR SUB-CUT QUANTITIES UNLESS APPROVAL BY THE ENGINEER IS GRANTED BEFORE WORK BEGINS.
8. PAVEMENT JOINTS SHALL NOT HAVE MORE THAN TWO SETS OF DOWEL BARS.
9. DO NOT SATURATE THE SUBGRADE DURING SAWING OPERATIONS.
10. DOWEL BARS RELEASE AGENTS SHALL BE MULTIPURPOSE LITHIUM GREASE (NLGI GRADE #2), TECTYL 506 OR APPROVED EQUAL.

M:\STANDARD SPECS & DETAILS\2025\Details\STR-17B\_CONCRETE PAVEMENT REPAIR FULL PANEL REPLACEMENT.dwg

City Plate No.:

STR-17B

Last Revision:

12/18/2020

Section:

3110

**STANDARD DETAILS**

**CONCRETE PAVEMENT REPAIR  
FULL PANEL REPLACEMENT**

**City of Minot**