

TYPE 1A (INFLOW)

- NO. 4 DEFORMED BARS IF NOT
USING EXPANSION MATERIAL
- 1/2" SMOOTH DOWELS IF USING
EXPANSION MATERIAL

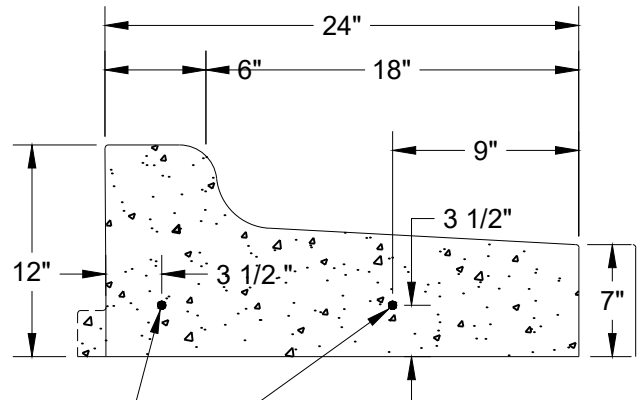

TYPE 1B (OUTFLOW)
AS APPROVED BY CITY ENGINEER

NOTES:

1. EXPANSION JOINTS SHALL BE 3/4 INCH WIDE, INSTALLED EVERY 100 FEET AND AS CLOSE TO LOT LINES AS POSSIBLE.
2. EXPANSION JOINTS SHALL BE INSTALLED AT THE INTERFACE OF CURB AND GUTTER AND GUTTER CONCRETE THAT HAS BEEN OR WILL BE POURED MONOLITHICALLY WITH DRIVEWAY APRONS.
3. EXPANSION JOINTS SHALL BE INSTALLED AS SHOWN ON THE PLANS AND CITY STANDARD DETAILS OR AS OTHERWISE DIRECTED BY THE ENGINEER.
4. ALL SMOOTH DOWELS SHALL BE GREASED OR COATED FOR DEBONDING, INSTALLED PERPENDICULAR TO THE JOIN, AND INSTALLED PARALLEL TO ADJACENT DOWELS.

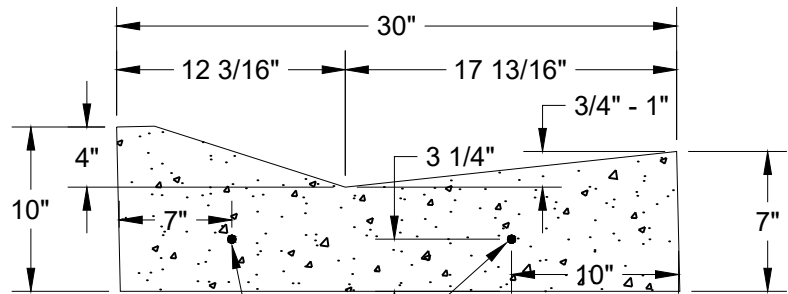

- NO. 4 DEFORMED BARS IF
NOT USING EXPANSION
MATERIAL
- 1/2" SMOOTH DOWELS IF
USING EXPANSION MATERIAL

TYPE 2 (MOUNTABLE)
AS APPROVED BY CITY ENGINEER

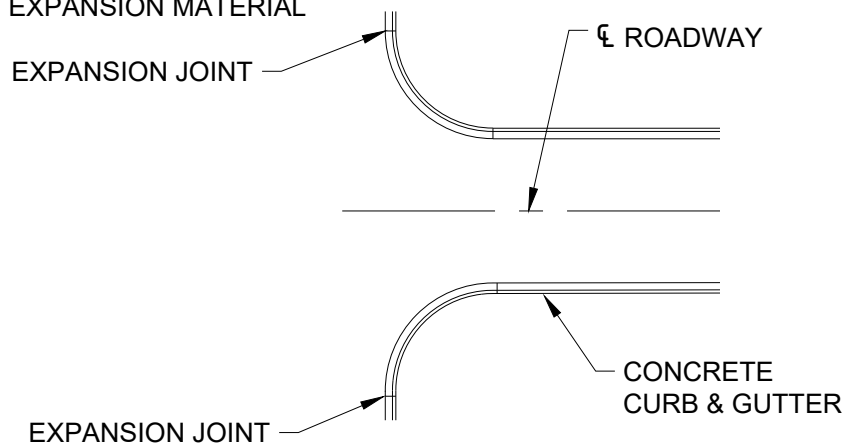

EXPANSION JOINT LOCATION AT CORNER

City Plate No.:

STR-2C

Last Revision:

02/24/2022

Section:

3200

STANDARD DETAILS

**CURB & GUTTER
REINFORCEMENT FOR REPAIRS**

City of Minot