

**ENERGY PARK 6TH ADDITION
TO THE CITY OF MINOT, NORTH DAKOTA**
(BEING LOTS 3, 4 AND 5, ENERGY PARK FIRST ADDITION AND LOT 1,
ENERGY PARK FOURTH ADDITION TO THE CITY OF MINOT, NORTH DAKOTA)



Scale 1" = 100'

0 100' 200'

- - SET #5 REBAR WITH CAP
● - EXISTING IRON IN PLACE

NOTES:

BASIS OF BEARING IS TRUE NORTH.

PLAT IS SUBJECT TO ALL PRIOR EASEMENTS OF RECORD.

BEARINGS AND DISTANCES MAY VARY FROM PREVIOUS PLATS DUE TO DIFFERENT METHODS OF MEASUREMENTS.

A 10' UTILITY EASEMENT IS ON THE STREETSIDE OF EVERY LOT UNLESS OTHERWISE NOTED.

COORDINATES SHOWN ARE NORTH DAKOTA STATE PLANE (NORTH ZONE).

COMBINATION FACTOR OF 1.000119213

CONVERT STATE PLANE DISTANCES TO GROUND DISTANCES.

NGS CONTROL USED TO ESTABLISH STATE PLANE COORDINATES: TRANSPORT, SURREY

BNSF RAILROAD

ENERGY

PARK

LOT 1

FIRST

ADDITION

ENERGY

PARK

LOT 2

THIRD

ADDITION

ENERGY

FOURTH

PUBLIC STORM WATER
MANAGEMENT AREALOT 1
(244105.12 SQ. FT.)
(5.60 ACRES)

LOT 3

N 89°51'56.4" W
641.41'LOT 2
(244504.67 SQ. FT.)
(5.15 ACRES)

LOT 4

N 89°51'56.4" W
641.49'LOT 3
(348865.84 SQ. FT.)
(7.96 ACRES)

LOT 5

S 89°49'25.5" W 1037.59'

LOT 1



CURVE	DELTA ANGLE	RADIUS	ARC	TANGENT	CHORD	CHORD BEARING
C1	50°00'26.6"	673.00'	587.39'	313.88'	568.92'	N 44°17'01.5" E

LINE	BEARING	DISTANCE
L1	N 00°10'33.9" E	48.68'
L2	S 89°47'36.1" W	80.00'
L3	S 00°09'44.8" W	10.00'

ACKERMAN SURVEYING & ASSOCIATES, INC., MINOT, NORTH DAKOTA

SHEET 1 OF 2
JOB #207-23N= 451415.54
E= 1798264.87

N 89°47'36.1" E 323.21'

10' UTILITY
EASEMENT45' DRAINAGE
UTILITY EASEMENT

LOT 1

S 00°14'10.0" W 301.13'

PUBLIC STORM WATER
MANAGEMENT AREA20' UTILITY
EASEMENT

PARK

ADDITION

2ND AVENUE SE

ENERGY

40' OVERHEAD
UTILITY EASEMENT

PARK

LOT 1

FIFTH

ADDITION

64TH STREET SE

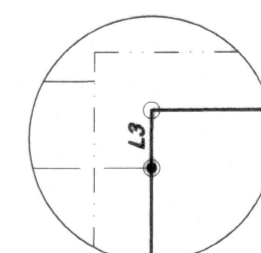
NW1/4SE1/4
SEC. 22-155-82N= 450076.99
E= 1798166.85POINT OF BEGINNING
SOUTHEAST CORNER LOT 5,
ENERGY PARK FIRST ADDITION

DETAIL "A"

DESCRIPTION

KNOW ALL MEN BY THESE PRESENTS THAT PMCO PARTNERS, LLC, BEING OWNERS AND PROPRIETORS OF LOTS 3, 4 AND 5 OF ENERGY PARK FIRST ADDITION AND LOT 1, ENERGY PARK FOURTH ADDITION TO THE CITY OF MINOT, NORTH DAKOTA, WHICH IS MORE PARTICULARLY DESCRIBED AS FOLLOWS; BEGINNING AT THE SOUTHEAST CORNER OF LOT 5, ENERGY PARK FIRST ADDITION TO THE CITY OF MINOT, NORTH DAKOTA, A PLAT ON RECORD AT THE WARD COUNTY RECORDERS OFFICE; THENCE S 89°49'25.5" W, A DISTANCE OF 1037.59 FEET; THENCE ALONG A CURVE TO THE LEFT A DISTANCE OF 587.39 FEET, SAID CURVE HAVING A RADIUS OF 673.00 FEET AND A CHORD OF 568.92 FEET WHICH BEARS N 44°17'01.5" E; THENCE N 00°10'33.9" E, A DISTANCE OF 621.83 FEET; THENCE N 89°47'36.1" E, A DISTANCE OF 398.16 FEET; THENCE N 00°13'56.0" E, A DISTANCE OF 311.13 FEET; THENCE N 89°47'36.1" E, A DISTANCE OF 323.21 FEET; THENCE S 00°14'10.0" W, A DISTANCE OF 301.23 FEET; THENCE S 89°47'36.1" W, A DISTANCE OF 80.00 FEET; THENCE S 00°09'44.8" W, A DISTANCE OF 1038.24 FEET TO THE POINT OF BEGINNING. TRACT CONTAINS 18.72 ACRES. HAVE CAUSED THE SAME TO BE SURVEYED AND PLATTED AS SHOWN HEREON TO BE KNOWN AS ENERGY PARK 6TH ADDITION TO THE CITY OF MINOT, NORTH DAKOTA AND HEREBY DONATE AND DEDICATE THE EASEMENTS AS SHOWN HEREON, TO THE PUBLIC FOR PUBLIC USE, IN WITNESS WHEREOF THE OWNER HAS HEREUNTO AFFIXED HIS SIGNATURE.

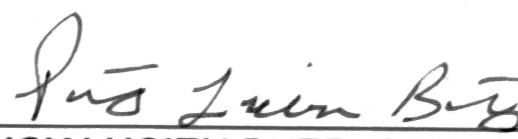
 PATRICK LUCIEN BUTZ (GENERAL PARTNER)
 PMCO PARTNERS LLC

STATE OF NORTH DAKOTA COUNTY OF WARD

ON THIS 24th DAY OF January, 2024, BEFORE ME, A NOTARY PUBLIC IN AND FOR SAID COUNTY AND STATE, APPEARED PATRICK LUCIEN BUTZ, WELL KNOWN TO ME TO BE THE PERSON DESCRIBED IN THE FOREGOING DESCRIPTION AND WHO ACKNOWLEDGED TO ME THAT HE EXECUTED THE SAME AS HIS OWN FREE ACT AND DEED.

MY COMMISSION EXPIRES:

ROBBY L. BERARD
Notary Public
State of North Dakota
My Commission Expires Dec. 28, 2027

 NOTARY PUBLIC, COUNTY OF WARD, STATE OF NORTH DAKOTA

SURVEYOR'S CERTIFICATE

I, ROBBY L. BERARD, REGISTERED LAND SURVEYOR, HEREBY CERTIFY THAT I HAVE SURVEYED AND PLATTED THE FOREGOING DESCRIBED TRACT OF LAND, THAT LOTS, DISTANCES, AREAS AND LOCATIONS AS SHOWN ON THE FOREGOING PLAT AND CONTAINED IN THE DESCRIPTION THEREOF, ARE TRUE AND CORRECT TO THE BEST OF MY INFORMATION, KNOWLEDGE AND BELIEF.

 ROBBY L. BERARD, RLS NO. 4727



STATE OF NORTH DAKOTA COUNTY OF WARD

ON THIS 22nd DAY OF January, 2024, BEFORE ME, A NOTARY PUBLIC IN AND FOR SAID COUNTY AND STATE, APPEARED ROBBY L. BERARD, REGISTERED LAND SURVEYOR, WELL KNOWN TO ME TO BE SUCH AND ACKNOWLEDGED TO ME THAT HE EXECUTED THE FOREGOING SURVEYOR'S CERTIFICATE AS HIS OWN FREE ACT AND DEED.

MY COMMISSION EXPIRES:

CHAD ATTERTON
Notary Public
State of North Dakota
My Commission Expires Nov. 11, 2024

 NOTARY PUBLIC, WARD COUNTY, STATE OF NORTH DAKOTA

APPROVED:

DATE:

CITY OF MINOT ENGINEER